

#28 Model number: 73BRB16783AH19

3 beds • 2 baths • 1248 sq.ft. • 16' width • 78' depth

Our home building facilities invest in continuous product and process improvements. Plans, dimensions, features, materials, specifications and availability are subject to change without notice or obligation. Renderings and floor plans are representative likenesses of our homes and may differ from the actual homes. We invite you to tour a Home Center near you and inspect the highest value in quality housing available or call (225) 644-3000 to speak with a Home Consultant. Copyright 2017, CMH. All rights reserved.

<https://www.luvhomesofgonzales.com>

LUV HOMES-GONZALES

**14258 AIRLINE HIGHWAY
GONZALES, LA 70737**

Monday - Thursday: 9am to 6pm
Friday: 9am to 6pm
Saturday: 9am to 5pm
Sunday: Closed

(225) 644-3000

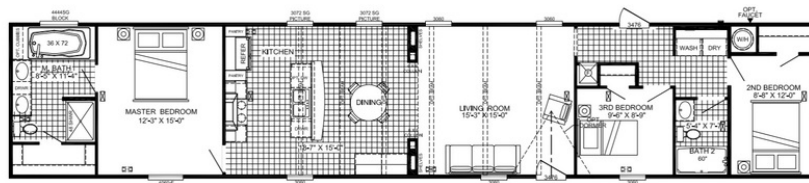

MODEL BRB-1833
3-BEDROOM / 2-BATH
16' x 82' - Approx. 1170 Sq. Ft.

Date: 2/19/18
 * All room dimensions include closets and square footage figures are approximate.



#28 Model number: 73BRB16783AH19

3 beds • 2 baths • 1248 sq.ft. • 16' width • 78' depth

Our home building facilities invest in continuous product and process improvements. Plans, dimensions, features, materials, specifications and availability are subject to change without notice or obligation. Renderings and floor plans are representative likenesses of our homes and may differ from the actual homes. We invite you to tour a Home Center near you and inspect the highest value in quality housing available or call (225) 644-3000 to speak with a Home Consultant. Copyright 2017, CMH. All rights reserved.

<https://www.luvhomesofgonzales.com>

LUV HOMES-GONZALES

**14258 AIRLINE HIGHWAY
 GONZALES, LA 70737**

Monday - Thursday: 9am to 6pm
 Friday: 9am to 6pm
 Saturday: 9am to 5pm
 Sunday: Closed

(225) 644-3000